

8 7 6 5 4 3 2 1

D

D

C

C

B

B

A

A

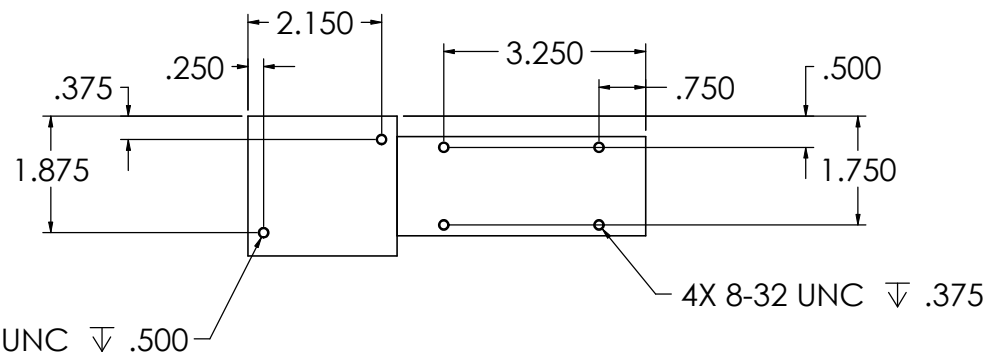
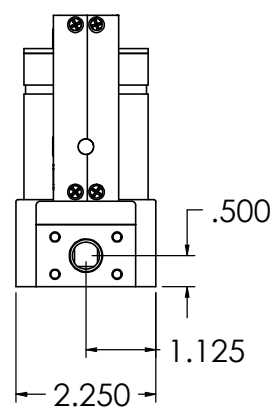
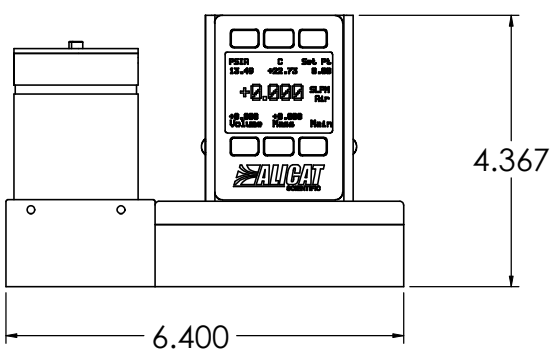
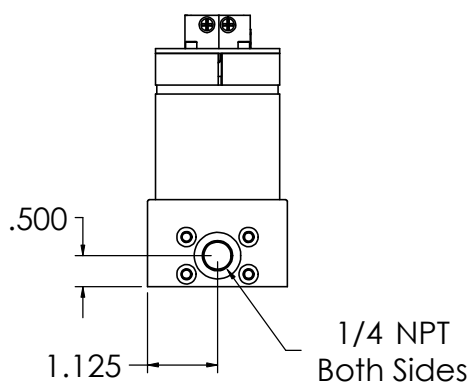
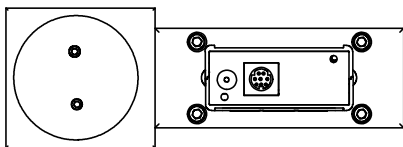

- Notes:
1. Break all sharp edges .005/.015 x 45 Deg. Radius optional.
 2. Transport as to prevent damage
 3. No nicks or dings allowed on machined surfaces.
 4. Remove all burrs

PROPRIETARY AND CONFIDENTIAL
 THE INFORMATION CONTAINED IN THIS DRAWING IS THE SOLE PROPERTY OF ALICAT SCIENTIFIC, INC. ANY REPRODUCTION IN PART OR AS A WHOLE WITHOUT THE WRITTEN PERMISSION OF ALICAT SCIENTIFIC, INC. IS PROHIBITED.

DATE	6/2/03
MATERIAL	303 Stainless
FINISH	--
DO NOT SCALE DRAWING	

DIMENSIONS ARE IN INCHES
 TOLERANCES:
 ANGULAR: ±0° 30'
 THREE PLACE DECIMAL ±.005
 FOUR PLACE DECIMAL ±.001

Alicat Scientific, Inc.	
2045 N. Forbes Blvd, Suite 103 Tucson, AZ 85745 520-290-6060 Ph. 520-290-0109 Fax	
SIZE	PART NO.
B	000000
DESCRIPTION	REV.
MC50SLPMD	0

8 7 6 5 4 3 2 1